

**OWLOTECH**

# **CLAMP HEADPHONE HOLDER**

MANUAL DE USUARIO • MANUAL D'USUARI • MANUEL DE L'UTILISATEUR  
BENUTZERHANDBUCH • MANUALE D'USO • MANUAL DO USUÁRIO

**USER MANUAL**

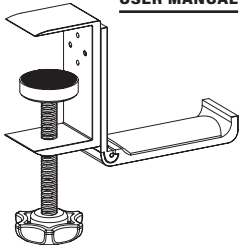

**EN**

SUPPORTS THICKNESS BELOW 50mm  
FOLDABLE DESIGN

**ES**

Soporta grosores inferiores a 50 mm  
DISEÑO PLEGABLE

**CAT**

SUPORTA UN GRUIX PER BAIX DE 50 mm  
DISSENY PLEGABLE

**FR**

Supporte les épaisseurs inférieures à 50 mm  
CONCEPTION PLIABLE

**DE**

UNTERSTÜTZT DICKEN VON UNTER 50mm  
FALTBARES DESIGN

**IT**

SUPPORTA SPESSORI INFERIORI A 50 mm  
DESIGN PIEGHEVOLE

**PT**

Suporta espessuras inferiores a 50 mm  
DESIGN DOBRÁVEL

**OWLOTECH**

**CLAMP  
HEADPHONE HOLDER**

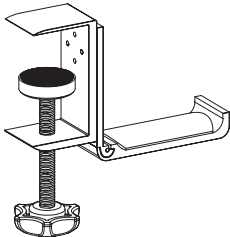

# TABLETOP MOUNTING

MONTAJE DE SOBREMESA | MUNTATGE A LA TAULA | MONTAGE SUR TABLE | TISCHPLATTENMONTAGE  
MONTAGGIO SU TAVOLO | MONTAGEM EM MESA

1

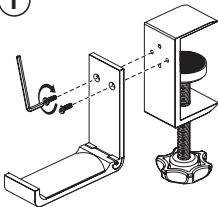

2

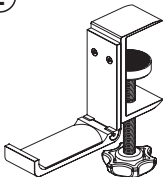

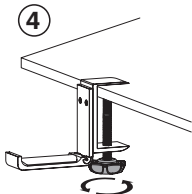
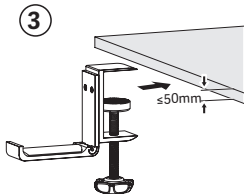

# WALL MOUNTING

MONTAJE EN PARED | MUNTATGE A LA PARET | FIXATION MURALE | WANDMONTAGE  
MONTAGGIO A PARETE | MONTAGEM NA PAREDE

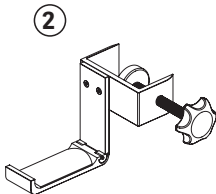
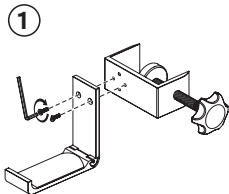

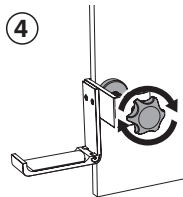
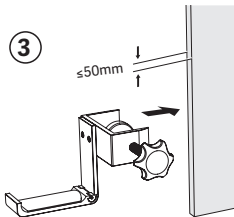

# OWLOTECH

[www.owlotech.com](http://www.owlotech.com)

